



Where **Passion** Meets **Precision**.<sup>TM</sup>  
Family-Owned • Made in the USA

NEWSLETTER MAY 2020

## Monthly Roundup

See what your friends at Krowne are up to.

### Touchless Sanitary Solutions

In the wake of COVID-19, we have received a number of calls from customers requesting products for Sanitary Solutions. These products have been installed for urgent projects which include; Healthcare facilities, Grocery/retail establishments, Construction sites and more.

Common products requested:

- Electronic Sensor faucets
- Hand Sink & Electronic Sensor Faucet packages
- Foot and knee pedal operated handwash stations
- Manual Faucets with Wrist Blade handles

New Sanitation requirements could soon mean that many customers will be switching from traditional manual faucets to Electronic Sensor faucets and other touchless options.

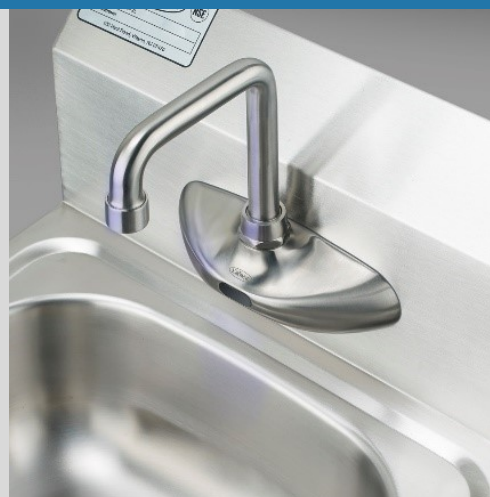

INTRODUCING

# FaucetFlex™

Review Your Selections

Body: 4" Deck Mount, VR Wristblade Handles

Spout: 6" Wide

Outlet: 1.5 GPM VR Aerator

Model Number: 15-301L-W-G4

Royal Series 4" Deck Mount with 6" Gooseneck Spout, VR Wristblade Handles, 1.5 GPM VR Aerator

List Price: \$232.00

Specification Sheet

This new and exciting tool will add over 2,000 unique configurations to our product offering. Users will be able to configure a faucet to meet the exact specification of their project in 3 easy steps:

**Step 1: Select a faucet base and handle type**

**Step 2: Select a spout**

**Step 3: Select an aerator or outlet**

After completing a configuration, an image and model number will be displayed along with list price and a PDF specification sheet that can be viewed or saved.

Don't miss the opportunity to share this with the commercial quotes department and engineers in your market.

FaucetFlex™

Watch the Demo

Share your Krowne pics using the hashtag **#poweredbykrowne** on Instagram.

## New Refrigeration Sliding Drawers

We are excited to announce the release of (3) new models of self-contained back bar refrigeration units with sliding drawers. We



have also created a new configuration method to allow you to easily mix door styles and finishes on our units. For a breakdown of this system check out our new [Spec Sheet](#) or build the unit in AQ which has been fully updated as well.

## 3D Bar Layout Renderings

We now offer free 3D renderings of all bar layouts using Revit design software. Our team of trained Revit designers can model out your exact layout to allow for a full 3D build of your bar equipment before you proceed to the purchasing stage.

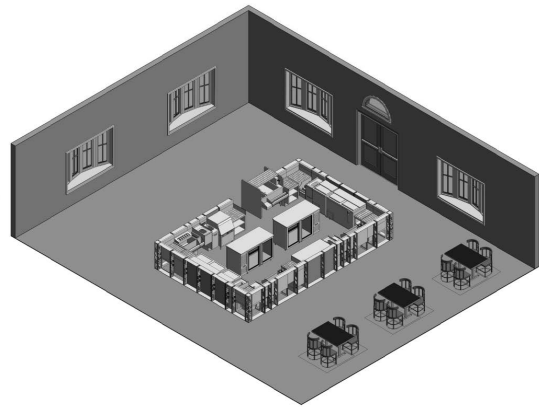

## Virtual Reality Demos

We now also offer free Virtual Reality demos built to your exact spec. This means we can model your entire bar in VR, allowing you to walk through your physical bar using Oculus VR goggles.

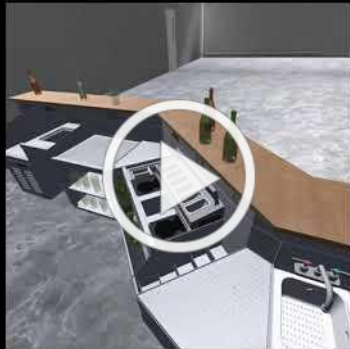

## New CO<sub>2</sub> Glass Froster

Our CO<sub>2</sub> Glass Froster sanitizes and chills glasses instantly while maintaining the ideal cocktail serving temperature. Enjoy improved taste profile and enhanced presentation with every use!

[View Product Details](#)



# Deep Cleaning Our Warehouse

Throughout the weekend of April 17th -19th, we hired a large professional cleaning crew to deep clean as well as “fog” both of our facilities to keep our team safe. The crew used a special disinfectant designed to eliminate COVID-19. This in-depth cleaning process will help make sure that our employees are protected as much as possible.

In addition, our new safety procedures include using digital thermometers to take temperatures and requiring face masks. We are now back to 100% operating capacity.



## Upping Our Mask Donation Goal to 20,000

This week we reached our goal of donating 10,000 N95 face masks!

With healthcare facilities facing massive shortages, these masks were difficult to source but we were able to leverage our supply chains to acquire them overseas quickly. Our team worked together to coordinate drop offs and shipments to

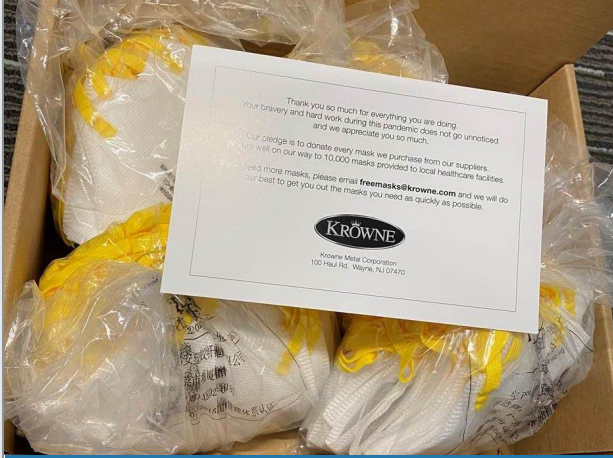

get these masks to the facilities that needed them most.

The supply of masks in local healthcare facilities is still low --- so we have decided to double our original commitment from 10,000 masks to 20,000 masks. We will continue this effort until the shortage ends.



## Case Study: Indian Trail Club Bar Upgrade



## Thank you for being a friend of Krowne.

We hope that you and your family are in good health during this challenging time.

Sincerely,

**The Team at Krowne**

